

THOMPSON
SEATTLE

110 STEWART ST
SEATTLE, WA

98101
(206) 623-4600

ABOUT

The contemporary 12-story urban landmark hotel was designed by Olson Kundig, the Seattle-based, internationally renowned architecture firm. Thompson Seattle is located near the city's legendary Pike Place Market designed with the history of the aviation industry in mind, showcasing a mid-century inspired style with carefully balanced edge rich in texture, materials and technology.

THE HOTEL

- 12 Stories
- 150 Rooms
- 10 Suites
- Valet Parking
- Multilingual Staff
- Private Car & Limo Service
- 24-Hour Fitness Center
- Complimentary Wi-Fi
- In-Room Dining
- 1 and 2-bedroom residences available



ACCOMMODATIONS

Mid-century modern guest rooms were designed with the intention of making travelers feel like residents. The effortlessly luxurious yet witty design mirrors local culture, while floor-to-ceiling windows in most rooms provide spectacular views to help guests unwind and escape

GUEST ROOM FEATURES

- Custom 400 thread count SFERRA linens
- Custom Sealy Tempur-Pedic mattress created exclusively for Thompson Hotels
- Floor-to-ceiling windows
- Bathroom features state-of-the-art rain shower, oversized Thompson signature robes
- Individual temperature controls
- Exclusive D.S. & Durga bath amenities
- Locally curated honor bar
- 42" Samsung Smart TV with complimentary movie library
- Bluetooth connected clock radio
- Laptop compatible in-room safe



DINING & ENTERTAINMENT

The Nest: An expansive, indoor-outdoor rooftop bar and lounge scene offering sweeping views of the city, Puget Sound and Olympic Mountain Range, and an outdoor lounge with a unique area for private events.

Conversation: An all-day dining concept providing a captivating yet comfortable background for connection. In this digital era where text messaging and screen swiping threaten the allure of face-to-face quality time, Conversation creates an environment where human connection takes priority.



MEETING & EVENT SPACE

With more than 5,000 square feet of indoor and outdoor meeting and event spaces, Thompson Seattle plays host to corporate and private events, intimate weddings, parties, receptions, high-profile dinners, and charity fundraisers.



HOTEL INFORMATION

- Check-In: 3pm/Check-Out: 11am
- Destination Fee: Yes

NEARBY

- Bell Street Pier 66 Cruise Terminal
- Benaroya Hall
- Chihuly Garden
- 5th Avenue Theatre
- MOHAI Museum
- MoPOP Museum
- Museum Of Flight
- Pike Place Market
- Pioneer Square
- Seattle Art Museum

AWARDS & ACCOLADES

- Conde Nast Traveler Reader's Choice Awards #1 Hotel in Pacific Northwest, 2019
- Conde Nast Traveler 10 Best Rooftop Bars in the US, 2018
- Conde Nast Traveler Reader's Choice Awards #1 Hotel in Seattle, 2018
- Jetsetter Favorite Hotels in Seattle, 2018
- MSN 30 Best Bars with a View Across the US, 2018
- Conde Nast Traveler Hot List, 2017

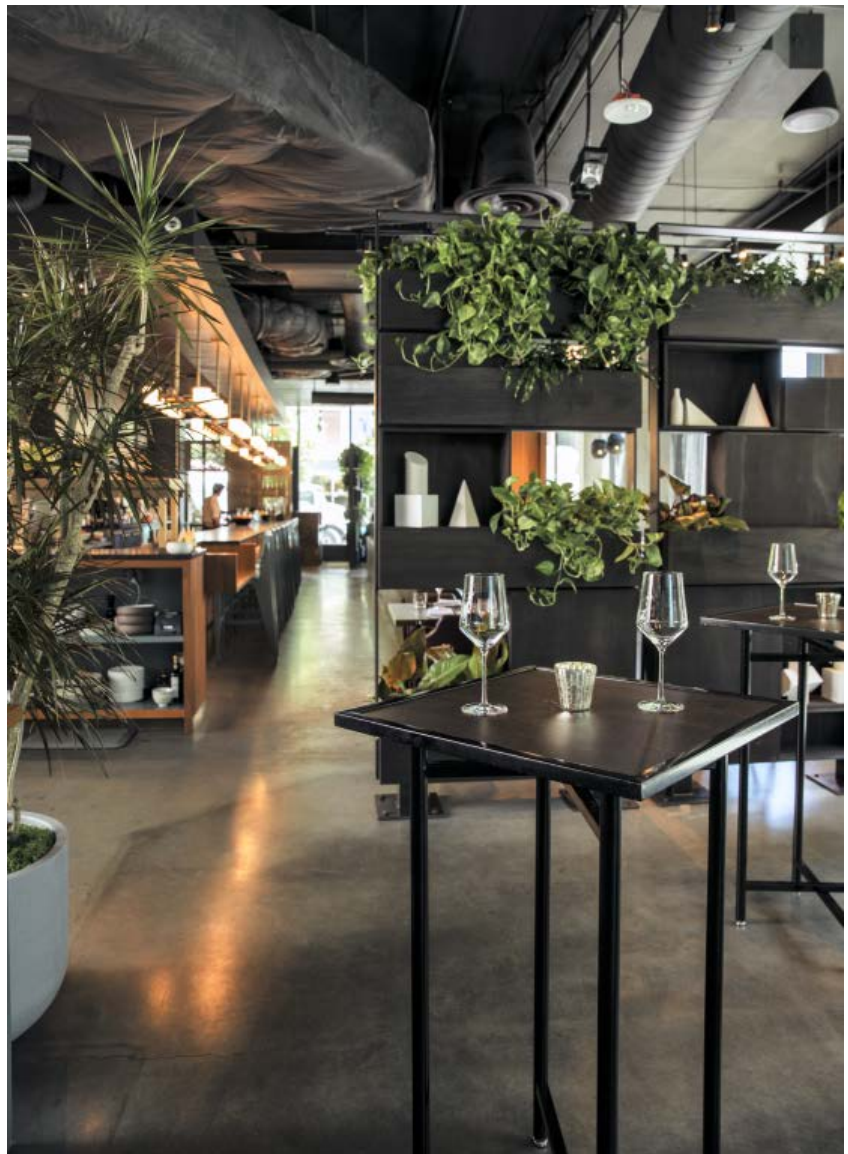

MEETING AND EVENT SPACES



Since Seattle's first flying machine took to the skies over Puget Sound in 1908, the spirit of aviation has run deep through the area's history—which is why you'll find Thompson Seattle's rooms, suites and event spaces subtly infused with textures, forms and materials inspired by flight.

And, it's why our second-floor meeting rooms are named for historic planes featured at Seattle's world-renowned Museum of Flight. Blackbird, Dreamliner, Flybaby and Grasshopper range from 500 to 1300 square feet and all feature dramatic floor-to-ceiling windows for an open, airy feel.

BLACKBIRD



With its “most efficient” cruising speed of more than three times the speed of sound flying at over 85,000 feet, the now-retired Blackbird reconnaissance plane is still the fastest and highest flying air-breathing production aircraft ever built.

Sales & Events

SeattleSales@thompsonhotels.com
206-743-0211

DREAMLINER



The distinctive swept wingtips set Boeing's most fuel-efficient airliner apart from the pack. The first major commercial airplane designed with a composite fuselage and wings, the Dreamliner features digital fly-by-wire technology and quiet, environmentally progressive operation.

GRASSHOPPER



These small, lightweight observation and liaison planes were manufactured and put into service quickly to aid the allied effort in World War II. Major General Innis Swift coined the Grasshopper nickname when he remarked to a pilot, "You looked like a damned grasshopper when you landed in those boondocks!"

FLYBABY



In 1962, the Experimental Aircraft Association put out a call for a low-cost, folding-wing plane that could be easily built, flown and towed or trailered between flights. The Flybaby was the winning entry, designed by lifelong aviation enthusiast and Seattle resident Peter Bowers, who enjoyed a distinguished career in the military and at Boeing.

Your event can also take flight at The Nest, our premier rooftop lounge—offering full buyouts of up to 250 guests or a 1500 square-foot semi-private event space for up to 100 guests; both with unmatched views of Pike Place Market, Elliott Bay and Puget Sound.

For corporate events, weddings, receptions and private parties, our team will create a unique experience for your guests, overseen by Executive Chef Kaleena Bliss and her team of culinary and beverage experts.

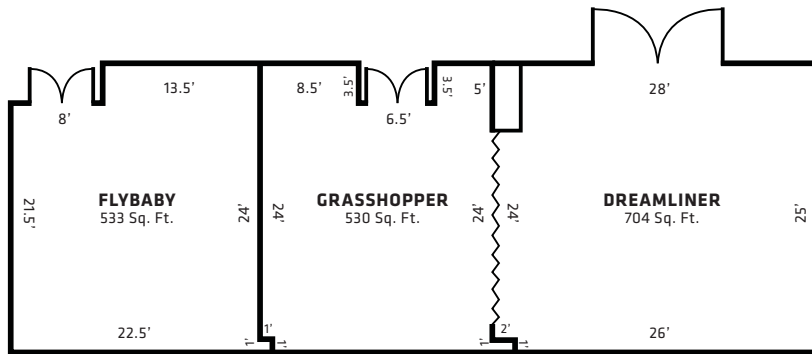

ROOM NAME	SQ. FT	THEATER	CLASSROOM	U-SHAPE	CONFERENCE	8/10 ROUNDS	RECEPTION
FLYBABY	533	45	24	18	22	32/40	55
GRASSHOPPER	530	60	27	18	16	32/50	55
DREAMLINER	704	60	36	24	22	40/50	95
GRASSHOPPER + DREAMLINER	1234	114	57	48	46	72/100	125

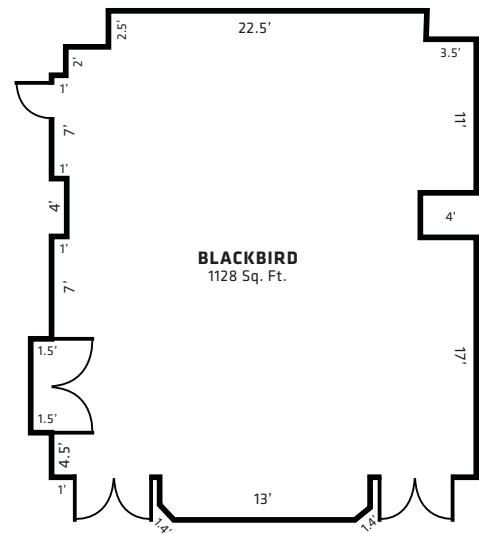

ROOM NAME	SQ. FT	THEATER	CLASSROOM	U-SHAPE	CONFERENCE	8/10 ROUNDS	RECEPTION
BLACKBIRD	1128	90	54	33	28	64/100	125

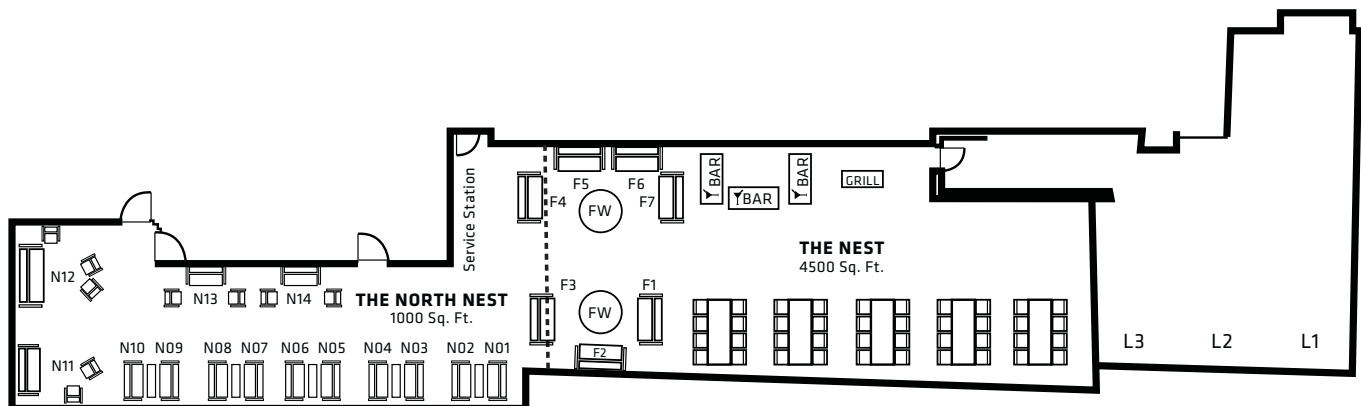

ROOM NAME	SQ. FT	RECEPTION
THE NEST	4500	250
THE NORTH NEST	1000	100



T H O M P S O N
SEATTLE